

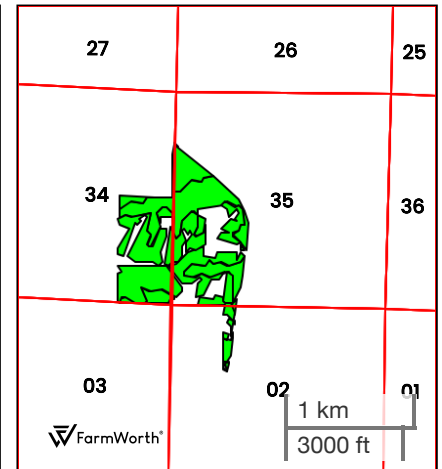

INEZ HICKAM TRUST FARM - (220.93 AC TOTAL, 175.84 AC TILLABLE)

TILLABLE SOILS

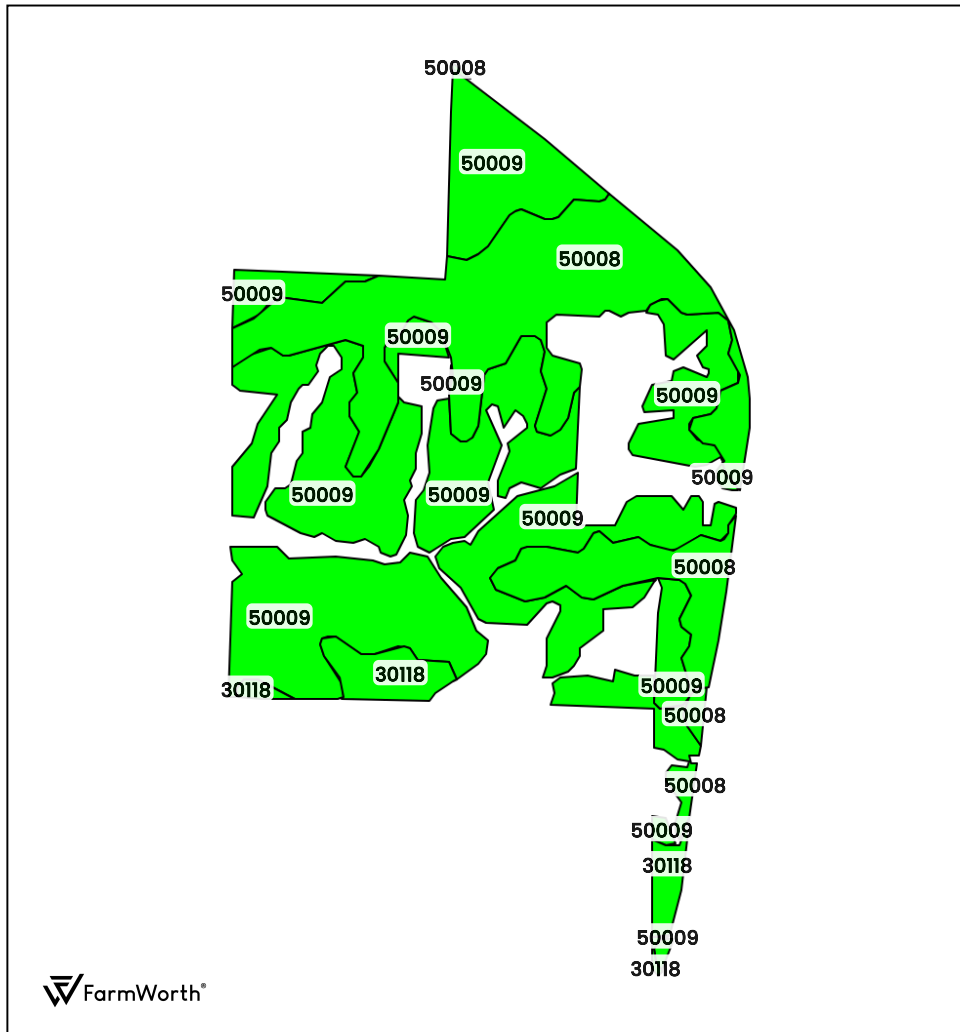

County: **Randolph County, MO**

Location: **35-55N-15W**

Township: **Chariton**

Acres: **175.84**

Date: **01/19/2026**



Field borders obtained from Farm Service Agency
as of 2008

FarmWorth, LLC makes no representations or warranties, express or implied, as to the accuracy of any information, data, numerical values, boundaries, or any other information generated through the use of FarmWorth.com. User is solely responsible for independently investigating and determining all information provided through FarmWorth.com prior to use and waives any and all claims against FarmWorth, LLC for any inaccuracies or inconsistencies in the information and/or data.

Code	Description	Acres	% of field	Overall NCCPI	Soil Class (Irr)	Soil Class (Non-Irr)	Drainage Class
50009	Keswick silt loam, 9 to 14 percent slopes, eroded	110.86	63.05 %	62	-	4	Somewhat poorly drained
50008	Keswick silt loam, 5 to 9 percent slopes, eroded	56.99	32.41 %	57	-	3	Somewhat poorly drained
30118	Lagonda silt loam, 5 to 9 percent slopes, eroded	7.99	4.54 %	60	-	3	Somewhat poorly drained
Average:				60.3			

Soils data provided by USDA and NRCS.